

1306 Pennsylvania Ave, Monaca, PA 15061-1879, Beaver County



N/A	N/A	N/A	N/A
Beds	Bldg Sq Ft	Lot Sq Ft	Sale Price
N/A	N/A	COM-NEC	N/A
Baths	Yr Built	Type	Sale Date

Owner Information

Owner Name:	Baker Patricia L	Tax Billing City & State:	Baden, PA
Owner Name 2:	Taormina Ernest J	Tax Billing Zip:	15005
Owner Occupied:	No	Tax Billing Zip+4:	9619
Tax Billing Address:	134 Green Forest Dr	Carrier Route:	R001

Location Information

Subdivision:	J T Taylors	Topography:	Flat/Level
Township:	Monaca Boro	Flood Zone Code:	X
Neighborhood Code:	Monaca-C342e	Flood Zone Date:	08/17/2015
Census Tract:	6034.00	Flood Zone Panel:	42007C0159D
Carrier Route:	C006		

Tax Information

Tax ID:	35-003-0704.000	Annual Tax:	\$288
Alt. Tax ID:	35-003-0704.000-01-1	County Tax:	\$69
Parcel ID:	350030704000	Township Tax:	\$77
Lot #:	3	School Tax:	\$142
Tax Area:	35		
Legal Description:	PTLOT 3 TR PL OB		

Assessment & Tax

Assessment Year	2017	2016	2015
Assessed Value - Total	\$2,650	\$2,650	\$2,650
Assessed Value - Land	\$2,650	\$2,650	\$2,650
YOY Assessed Change (\$)	\$0	\$0	
YOY Assessed Change (%)	0%	0%	
Market Value - Total	\$5,300	\$5,300	\$5,300
Market Value - Land	\$5,300	\$5,300	\$5,300

Tax Year	Total Tax	Change (\$)	Change (%)
2015	\$263		
2016	\$266	\$3	1.21%
2017	\$288	\$22	8.18%

Characteristics

Land Use - County:	Undeveloped And Unused Ind	# of Buildings:	1
Land Use - CoreLogic:	Commercial (NEC)	Total Units:	2
Lot Acres:	0.06	Building Type:	Commercial
Lot Frontage:	22		

Last Market Sale & Sales History

Owner Name:	Baker Patricia L	Owner Name 2:	Taormina Ernest J
Sale/Settlement Date	12/28/2009		10/1962

Recording Date	02/16/2010	
Sale Price		\$2,000
Nominal	Y	Y
Buyer Name	Baker Patricia L	Taormina Ernest & Mary
Buyer Name 2	Taormina Ernest J	Taormina Mary
Seller Name	Taormina Mary J	Owner Record
Document Number	3360207	827-204
Document Type	Deed (Reg)	Deed (Reg)

Property Map

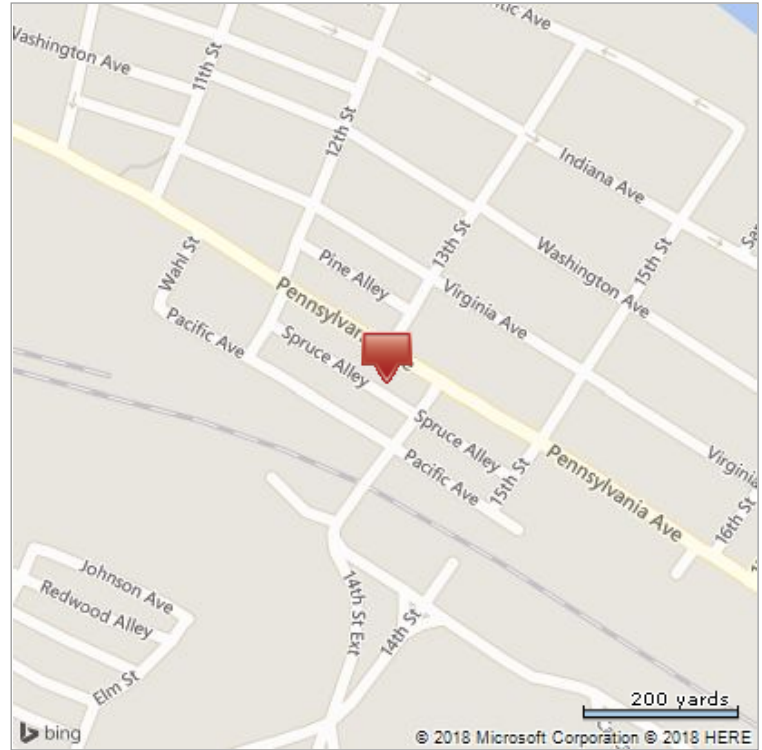
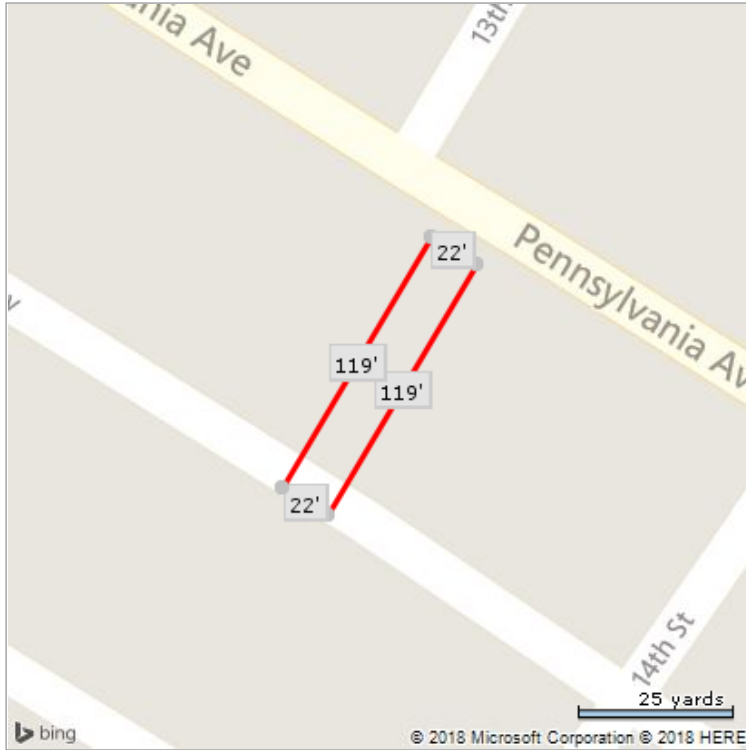

*Lot Dimensions are Estimated